

MEC@Fire

Electromagnetic Door Holders



FIRE PROTECTION

IN CONFORMITY WITH

EN 1155 - NFS61937 - BS 5839 part 3

HE & BS Benson Ltd
1 Laureate Industrial Estate
Exning Road
Newmarket
Suffolk UK
CB8 0AR

T. +44(0)1638 663535 – 663130
F. +44(0)1638 667434
E. sales@hebsbenson.co.uk
www.hebsbenson.co.uk



Products

STANDARD Series

Series M 5200 - M5400

Electromagnetic door holders mounted in a steel box with release button.

Two pass cable.

Protective diode.

Door position monitoring.

REINFORCED Series

Series M 8400

Floor mounting Electromagnetic door holders mounted in reinforced aluminium housing, with release button and protection diode.

Series M 9200 - M 9400

Floor mounting Electromagnetic door holders mounted in reinforced aluminium housing, with release button and protection diode.

PROFESSIONAL Series

Series M 10200 - M 10400

FLUSH mounting electromagnetic door holders with release button and protection diode.

ACCESSORIES

Telescopic bracket wall mounting.

Universal bracket.

Floor mounting bracket and Mounting boxes.



HE & BS Benson Ltd
1 Laureate Industrial Estate
Exning Road
Newmarket
Suffolk UK
CB8 0AR

T. +44(0)1638 663535 – 663130
F. +44(0)1638 667434
E. sales@hebsbenson.co.uk
www.hebsbenson.co.uk



Electromagnetic DOOR HOLDERS

Steel box pass-cables

with release button - surface mounting

SERIES **M 5200**
M 5400



Door holders are generally linked to a fire system and that will automatically release the doors in case of fire by switching the power off. If required, it can be also manually operated by the release button.

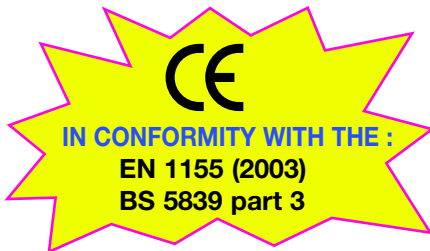

STANDARD FEATURE

Both models M 5200 and M 5400 of electromagnetic door holders for fire proof doors are in a steel box, have a spring loaded device to eliminate the residual magnetism, release button and two plastic pass-cables on the top.

The M 5200 and M 5400 are also available with two different standard specifications:

. Series M 5200 D and M 5400 D

Including the PCB circuit with protection diode and two electrical terminal connections.

. Series M 5200 A and M 5400 A

Including the PCB circuit with the monitoring state of the fire proof door and electrical terminal connection.

Both M 5200 and M 5400 electromagnetic door holders can be suited for every type of fire system protection.

Product individually packed with fitting instructions and white galvanised steel amortized flat or swivel keeper plate.

TECHNICAL SPECIFICATIONS

Holding force

SERIES M 5200 20 daN

SERIES M 5400 40 daN

Voltage

Available versions : 24 Vdc or 48 Vdc

Nominal power at 20°C

SERIES M 5200 0.6 watt

SERIES M 5400 1,6 watt

Electrical protection class

III

Protection rating

IP 42 - EN 60529

Electrical connection

Terminal board

Box colour

Grey RAL 9002 painted steel

ACCESSORIES :

- **AC 912ME51** Universal mounting bracket length 150mm to mount the door holder in a "wall" or "floor" position, allows the passage of power cables. Body in grey RAL 9002 painted steel.

- **AC 912ME52** Universal mounting bracket length 250mm to mount the door holders in a "wall" or "floor" position, allows the passage of power cables. Body in grey RAL 9002 painted steel.

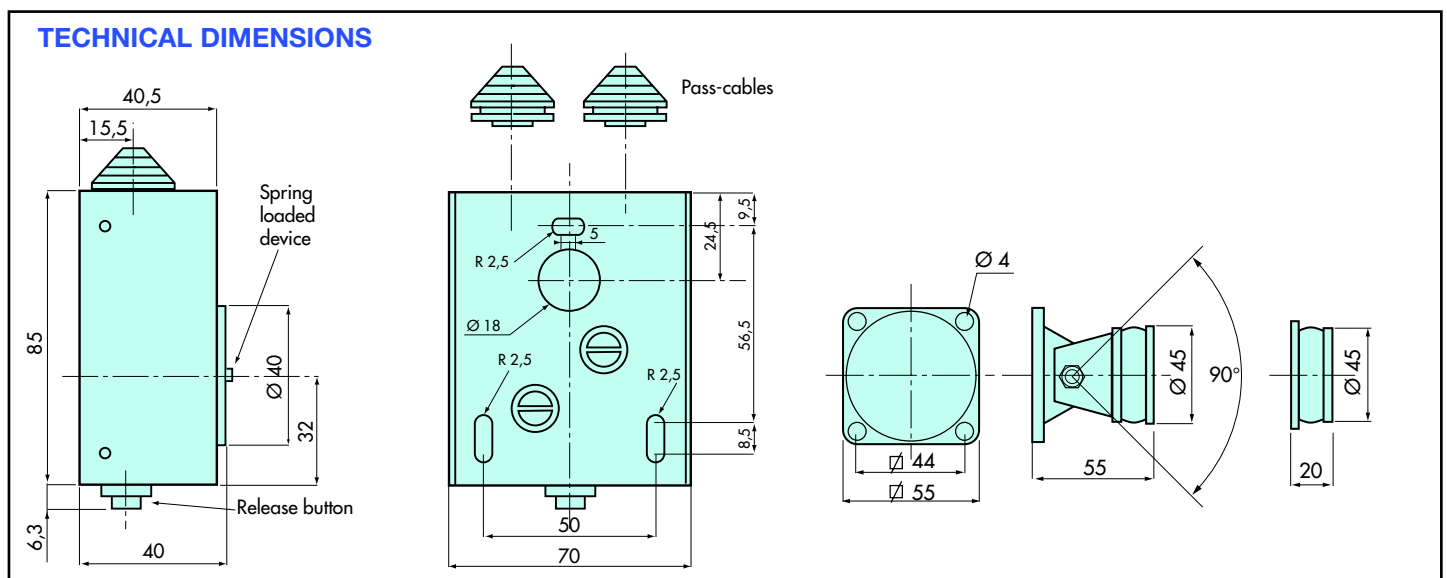

Electromagnetic DOOR HOLDERS
Steel box pass-cables
with release button - surface mounting

SERIES **M 5200**
M 5400

ITEMS	Holding force	Voltage	Release button	PCB DIODE	Monitoring fire door position	Pass-cables mini 5 mm maxi 16 mm	Keeper plate
-------	---------------	---------	----------------	-----------	-------------------------------	----------------------------------	--------------

SERIES 5200

M 5211	20 daN	24 Vdc	YES	NO	NO	YES	SWIVEL
M 5221	20 daN	48 Vdc	YES	NO	NO	YES	SWIVEL
M 5211 D	20 daN	24 Vdc	YES	YES	NO	YES	SWIVEL
M 5221 D	20 daN	48 Vdc	YES	YES	NO	YES	SWIVEL
M 5211 A	20 daN	24 Vdc	YES	NO	YES	YES	SWIVEL
M 5221 A	20 daN	48 Vdc	YES	NO	YES	YES	SWIVEL
M 5212	20 daN	24 Vdc	YES	NO	NO	YES	FLAT
M 5222	20 daN	48 Vdc	YES	NO	NO	YES	FLAT
M 5212 D	20 daN	24 Vdc	YES	YES	NO	YES	FLAT
M 5222 D	20 daN	48 Vdc	YES	YES	NO	YES	FLAT
M 5212 A	20 daN	24 Vdc	YES	NO	YES	YES	FLAT
M 5222 A	20 daN	48 Vdc	YES	NO	YES	YES	FLAT

SERIES 5400

M 5411	40 daN	24 Vdc	YES	NO	NO	YES	SWIVEL
M 5421	40 daN	48 Vdc	YES	NO	NO	YES	SWIVEL
M 5411 D	40 daN	24 Vdc	YES	YES	NO	YES	SWIVEL
M 5421 D	40 daN	48 Vdc	YES	YES	NO	YES	SWIVEL
M 5411 A	40 daN	24 Vdc	YES	NO	YES	YES	SWIVEL
M 5421 A	40 daN	48 Vdc	YES	NO	YES	YES	SWIVEL
M 5412	40 daN	24 Vdc	YES	NO	NO	YES	FLAT
M 5422	40 daN	48 Vdc	YES	NO	NO	YES	FLAT
M 5412 D	40 daN	24 Vdc	YES	YES	NO	YES	FLAT
M 5422 D	40 daN	48 Vdc	YES	YES	NO	YES	FLAT
M 5412 A	40 daN	24 Vdc	YES	NO	YES	YES	FLAT
M 5422 A	40 daN	48 Vdc	YES	NO	YES	YES	FLAT

MOUNTING EXEMPLE

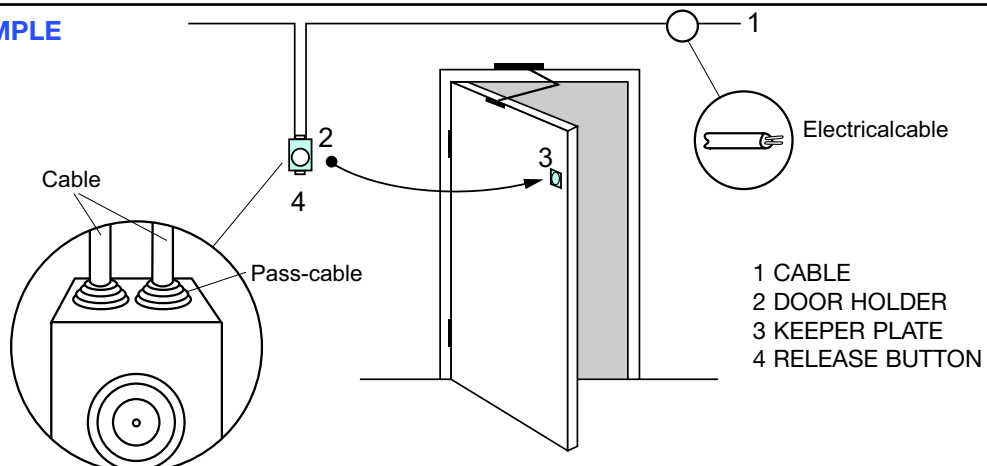

Electromagnetic DOOR HOLDERS

Reinforced aluminium housing - with release button

SERIES

M 8400 D

Floor mounting - IP 52



STANDARD FEATURE

Electromagnetic door holder for fire proof doors, mounted in a reinforced aluminium housing, has a spring loaded device to eliminate the residual magnetism, including the diode of protection, release button and electrical terminal connection.

Series M 8400 electromagnetic door holder is specially designed for use in areas of vandalism (school, colleges, public area...) or industrial area (warehouse, exhibition centre, supermarket, hospital...) or can be suited for every type of fire system protection.

Product individually packed with fitting instructions and white galvanised steel amortized flat keeper plate.

TECHNICAL SPECIFICATIONS

Holding force

SERIES M 8400 D 40 daN

Voltage

Available versions : 24 Vdc or 48 Vdc

Nominal power at 20°C

SERIES M 8400 D 2 watt

Electrical protection class

III

Protection rating

IP 52 - EN 60529

Electrical connection

Terminal board

Box colour

Grey RAL 9002 painted steel

Door holders are generally linked to a fire system that will automatically release the doors in case of fire by switching the power off. If required, it can be also manually operated by the release button.



TECHNICAL DIMENSIONS

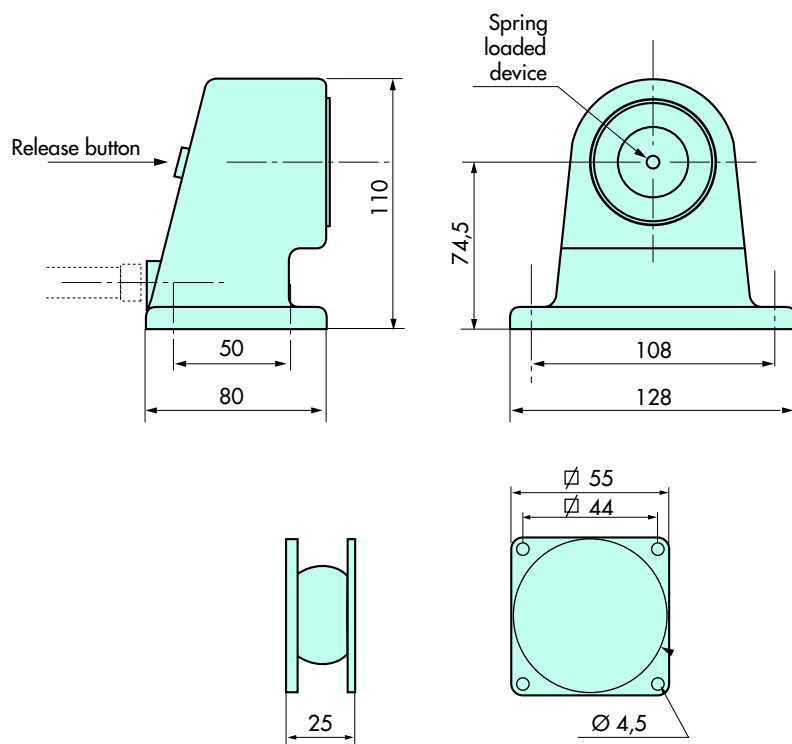
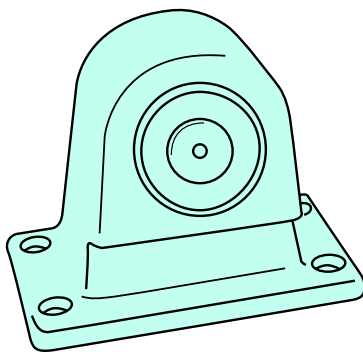

Electromagnetic DOOR HOLDERS
Reinforced aluminium housing - with release button
Floor mounting - IP 52

SERIES M 8400 D

ITEMS	Holding force	Voltage	Release button	DIODE	Keeper plate
-------	---------------	---------	----------------	-------	--------------

SERIES M 8400 D

M 8412 D	40 daN	24 Vdc	YES	YES	FLAT
M 8422 D	40 daN	48 Vdc	YES	YES	FLAT

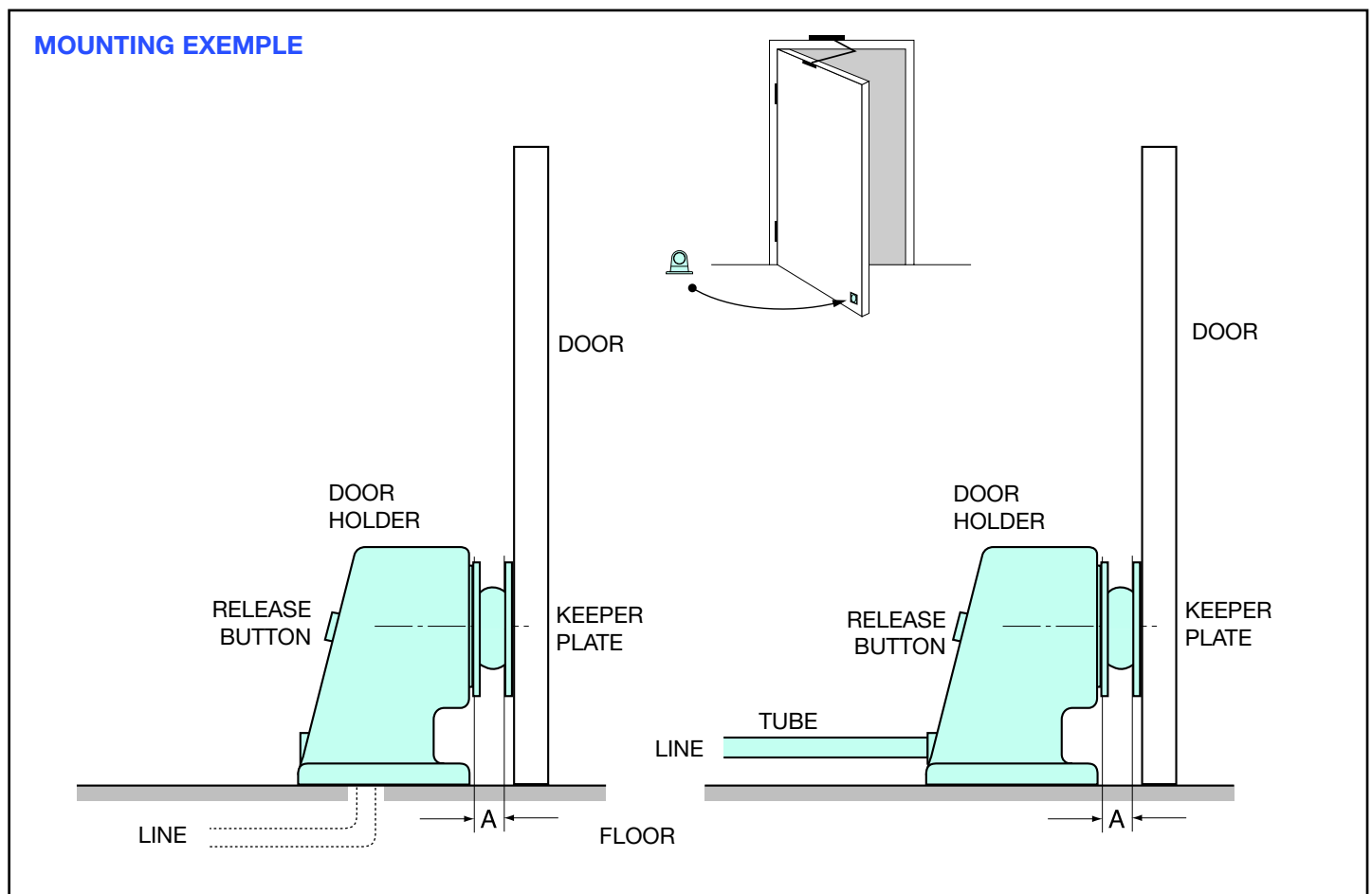

Please note:
 It must be possible to release a fire protection door held open by an electromagnet with a hand switch which is not hidden by the door.
 (not included)

Electromagnetic DOOR HOLDERS

Reinforced aluminium housing - with release button

Surface mounting - IP 52

**SERIES M 9200 D
M 9400 D**



STANDARD FEATURE

Electromagnetic door holder for fire proof doors, mounted in a reinforced aluminium housing, has a spring loaded device to eliminate the residual magnetism, including the diode of protection, release button and electrical terminal connection.

Series M 9200 and M 9400 electromagnetic door holders are specially designed for use in areas of vandalism (school, colleges, public area...) or industrial area (warehouse, exhibition centre, supermarket, hospital...), or can be suited for every type of fire system protection.

Product individually packed with fitting instructions and white galvanised steel amortized flat keeper plate.

TECHNICAL SPECIFICATIONS

Holding force

SERIES M 9200 D 20 daN
SERIES M 9400 D 40 daN

Voltage

Available versions : 24 Vdc or 48 Vdc
Only for SERIES M 9200 115 or 240 Vac

Nominal power at 20°C

SERIES M 9200 D 0,6 watt
SERIES M 9400 D 1,6 watt

Electrical protection class

III for 24 or 48 Vdc / I for 115 or 240 Vac

ATTENTION! 115 or 240 Vac units are insulation **class I** and the earth lead must be wired between the earth connector and the earth terminal on the metal mounting box.

Protection rating

IP 52 - EN 60529

Electrical connection

Terminal board

Box colour

Grey RAL 9002 painted steel

Door holders are generally linked to a fire system that will automatically release the doors in case of fire by switching the power off. If required, it can be also manually operated by the release button.

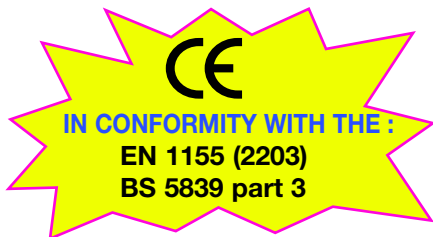

TECHNICAL DIMENSIONS

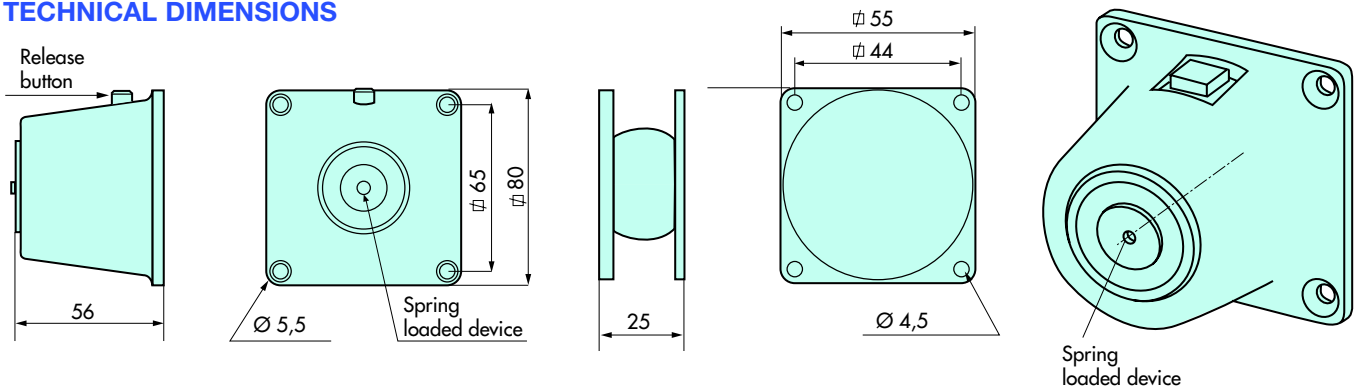

ACCESSORIES FOR SERIES M 9200D - M 9400 D



Series M 9200-M 9400 with AC 916.20.06 - 45 mm



Series M 9200 - M 9400 with AC 916.20.31- 150 mm



Series M 9200 - M 940D with AC 916.20.32 - 250 mm



Electromagnetic DOOR HOLDERS
Reinforced aluminium housing - with release button
Surface mounting - IP 52

SERIES **M 9200 D**
M 9400 D

ITEMS	Holding force	Voltage	Release button	DIODE	Keeper plate
-------	---------------	---------	----------------	-------	--------------

SERIES M 9200 D

M 9212 D	20 daN	24 Vdc	YES	YES	FLAT
M 9222 D	20 daN	48 Vdc	YES	YES	FLAT

SERIES M 9400 D

M 9412 D	40 daN	24 Vdc	YES	YES	FLAT
M 9422 D	40 daN	48 Vdc	YES	YES	FLAT

MOUNTING EXEMPLE

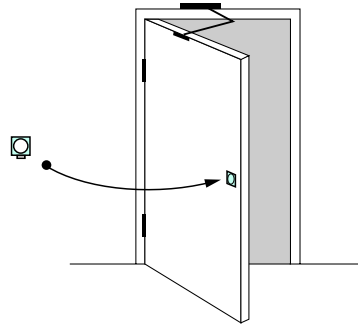

Please note:

It must be possible to release a fire protection door held open by an electromagnet with a hand switch which is not hidden by the door. (not included)

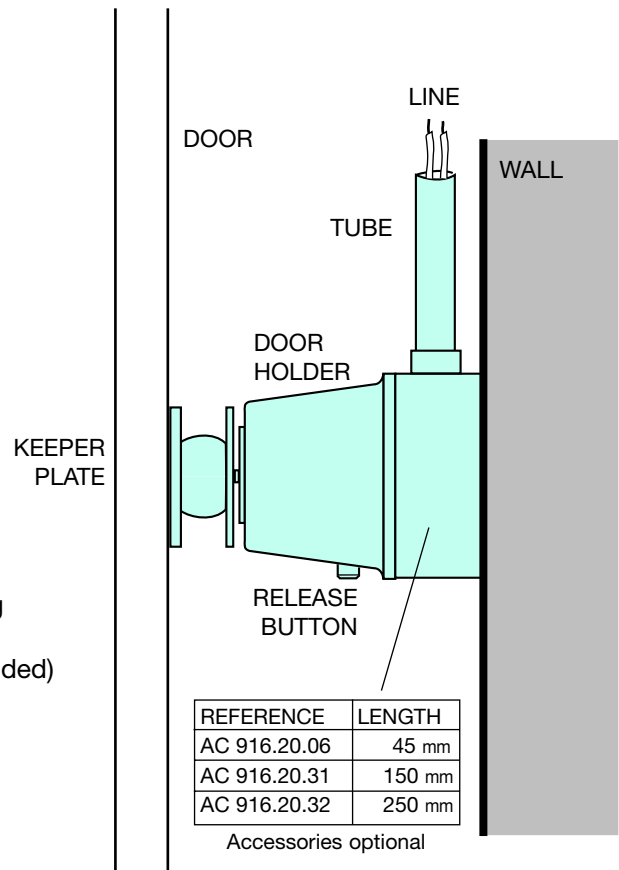
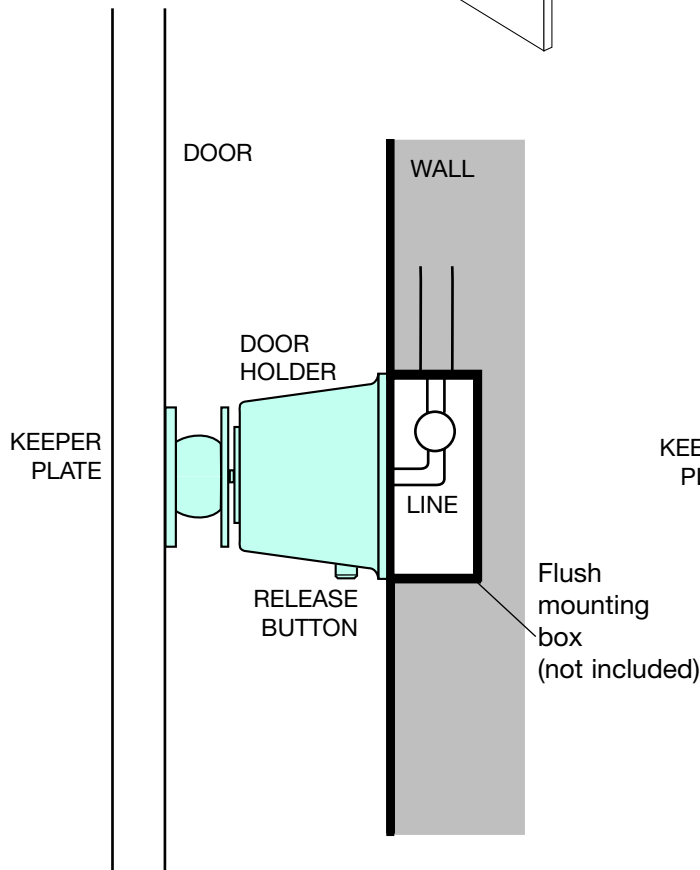

Electromagnetic DOOR HOLDERS
Steel construction - with release button
Flush mounting

SERIES **M 10200**
M 10400

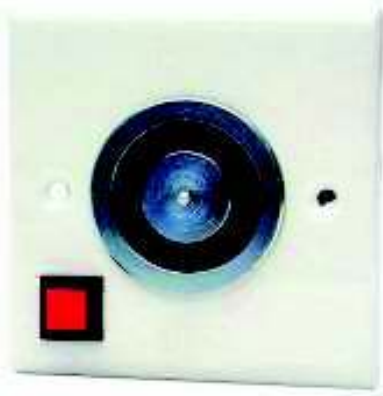

STANDARD FEATURE

Both models M 10200 and M 10400 of electromagnetic door holders for fire proof doors are in steel construction, have a spring loaded device to eliminate the residual magnetism and a release button.

Series M 10200 and 10400 electromagnetic door holders are specially designed for use in areas like exhibition centre or hospitals and hotels.... The M 10200 and M 10400 Series are also with one different available standard specification:

. Series M 10200 D and M 10400 D

Including the PCB circuit with protection diode and two electrical terminal connections.

Both series M 10200 and M 10400 electromagnetic door holders can be suited for every type of fire system protection.

Product individually packed with fitting instructions and white galvanised steel amortized flat or swivel keeper plate.

TECHNICAL SPECIFICATIONS

Holding force

SERIES M 10200 D	20 daN
SERIES M 10400 D	40 daN

Voltage

Available versions:	24 Vdc or 48 Vdc
Only for series M 10200:	115 Vac or 240 Vac

Nominal power at 20°C

SERIES M 10200 D	0,6 watt
SERIES M 10400 D	1,6 watt

Electrical protection class

	III for 24 or 48 Vdc / I for 115 or 240 Vac
--	---

ATTENTION! 115 or 240 Vac units are insulation **class I** and the earth lead must be wired between the earth connector and the earth terminal on the metal mounting box.

Protection rating

IP 42 - EN 60529

Electrical connection

Terminal board

Colour

Gray RAL 9002 painted

Door holders are generally linked to a fire system that will automatically release the doors in case of fire by switching the power off. If required, it can be also manually operated by the release button.



TECHNICAL DIMENSIONS

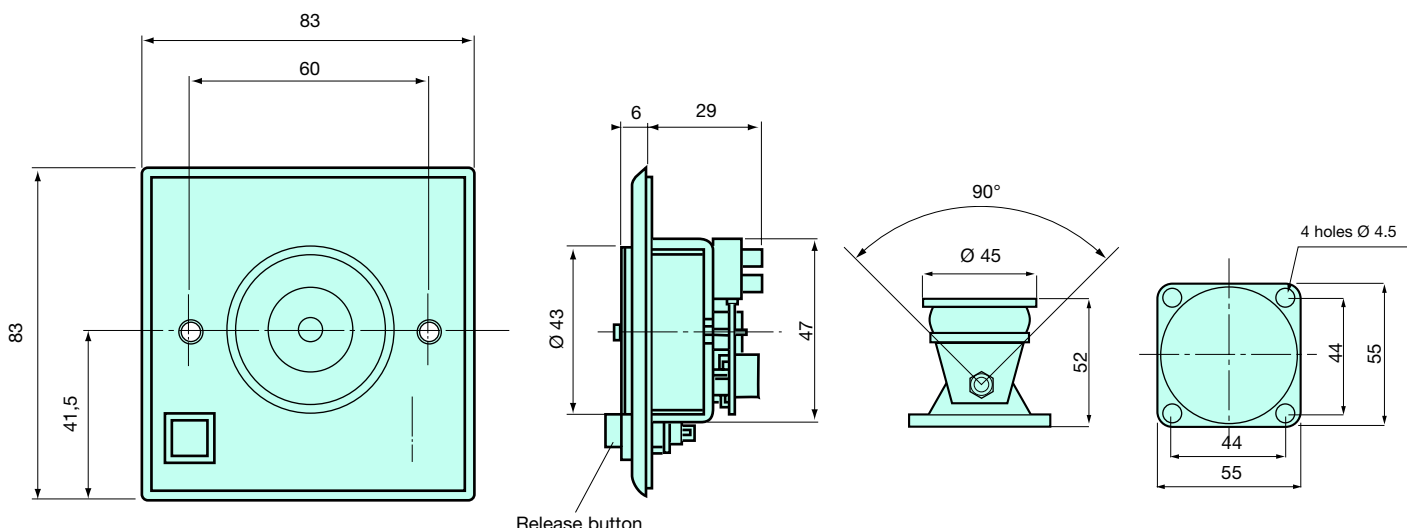

Release button

Electromagnetic DOOR HOLDERS
Steel construction - with release button
Flush mounting

SERIES **M 10200**
M 10400

ITEMS	Holding force	Voltage	Release button	PCB DIODE	Keeper plate
-------	---------------	---------	----------------	-----------	--------------

SERIES 10200

M 10211	20 daN	24 Vdc	YES	NO	SWIVEL
M 10221	20 daN	48 Vdc	YES	NO	SWIVEL
M 10281	20 daN	115 Vac	YES	NO	SWIVEL
M 10291	20 daN	240 Vac	YES	NO	SWIVEL
M 10211 D	20 daN	24 Vdc	YES	YES	SWIVEL
M 10221 D	20 daN	48 Vdc	YES	YES	SWIVEL
M 10212	20 daN	24 Vdc	YES	NO	FLAT
M 10222	20 daN	48 Vdc	YES	NO	FLAT
M 10282	20 daN	115 Vac	YES	NO	FLAT
M 10292	20 daN	240 Vac	YES	NO	FLAT
M 10212 D	20 daN	24 Vdc	YES	YES	FLAT
M 10222 D	20 daN	48 Vdc	YES	YES	FLAT

SERIES 10400

M 10411	40 daN	24 Vdc	YES	NO	SWIVEL
M 10421	40 daN	48 Vdc	YES	NO	SWIVEL
M 10411 D	40 daN	24 Vdc	YES	YES	SWIVEL
M 10421 D	40 daN	48 Vdc	YES	YES	SWIVEL
M 10412	40 daN	24 Vdc	YES	NO	FLAT
M 10422	40 daN	48 Vdc	YES	NO	FLAT
M 10412 D	40 daN	24 Vdc	YES	YES	FLAT
M 10422 D	40 daN	48 Vdc	YES	YES	FLAT

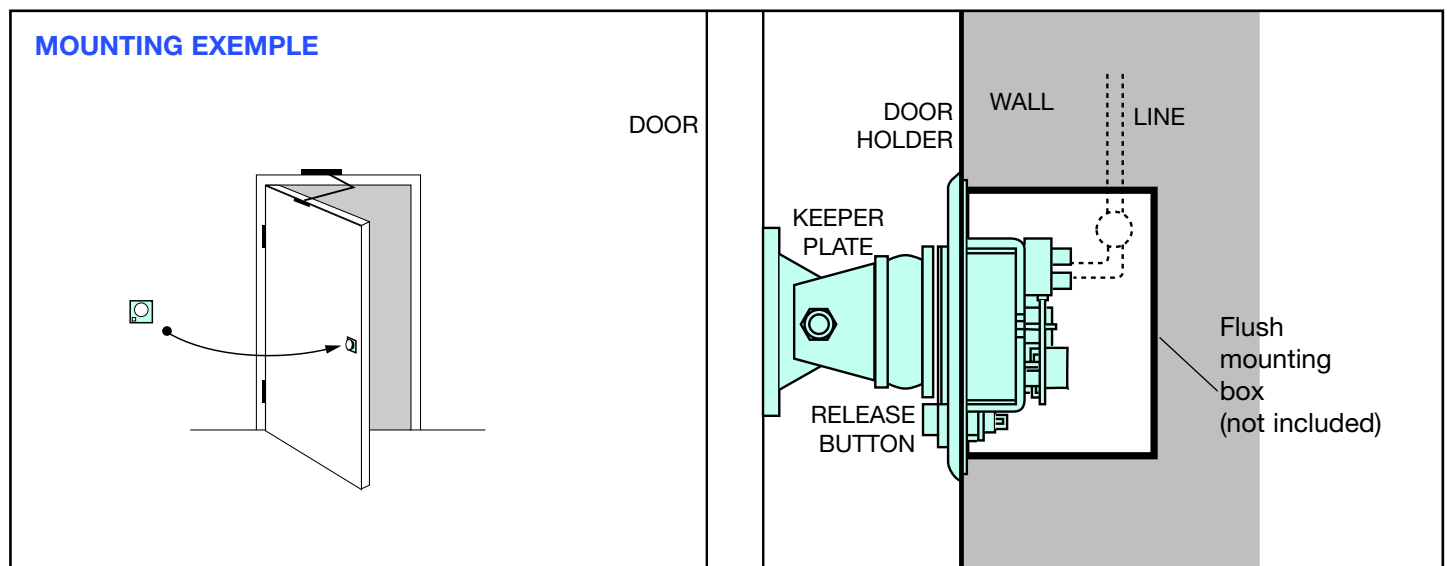

Electromagnetic DOOR HOLDER Accessories

Telescopic bracket wall mounting

AC 912 ME 55



Black galvanised steel bracket .
Adjustable length.
Supplied with screws kit.

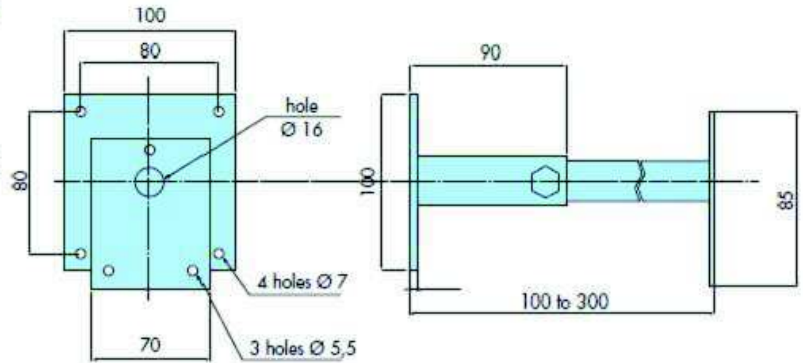

Universal bracket

L	ITEMS
150	AC 912 ME 51
250	AC 912 ME 52



Wall mounting



Floor mounting

Steel bracket.
Colour RAL 9002.
It can be used at wall or at floor.
Supplied with screws kit.

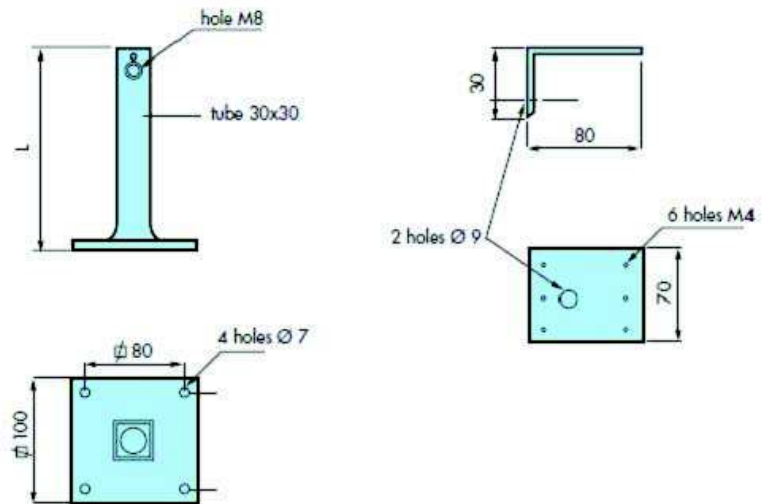

Bracket floor mounting

AC 916 ME 50



Floor mounting

Steel bracket.
Colour RAL 9002.
Supplied kit with screws kit.

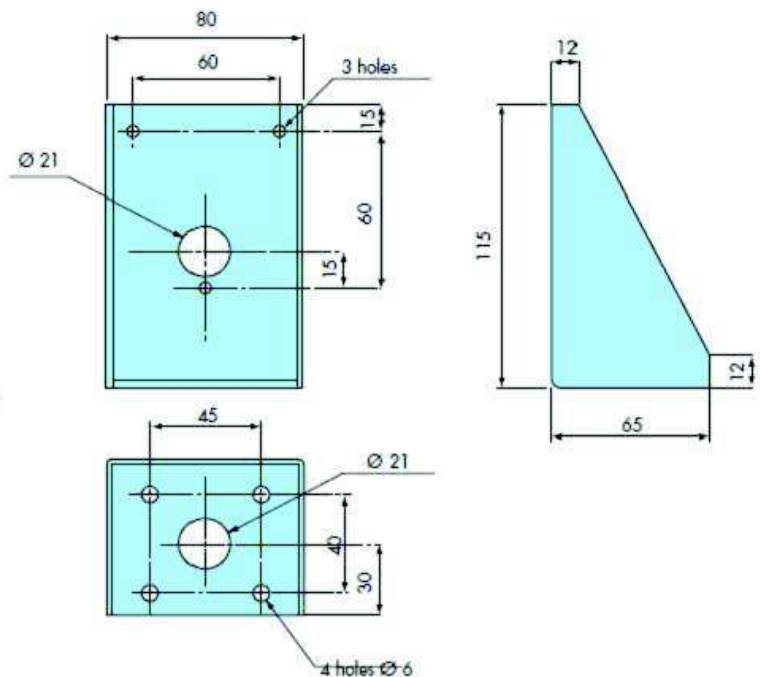

Electromagnetic DOOR HOLDER Accessories

Mounting box length 45 mm.

AC 916.20.07



Wall mounting

To mount series M10200 - M10400 door holders in a surface position.
Box in aluminium with two plastic pass-cables (min 5mm - max 16mm)
Press-tubes are optional

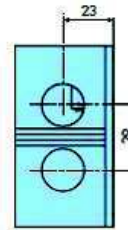
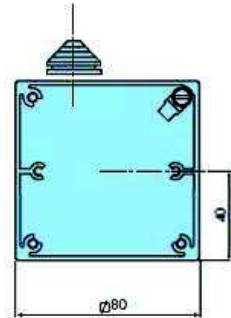

Mounting bracket length 150 mm.

AC 916.20.31



Wall mounting

To mount Series M10200 - M10400 door holders in a surface position
Box in aluminium with two plastic pass-cables (min 5mm - max 16mm)
Press tubes are optional
Length 150mm

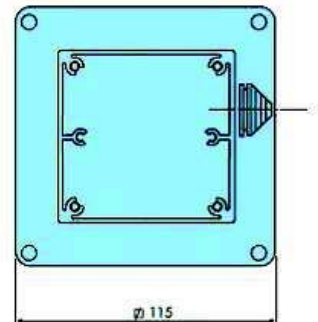
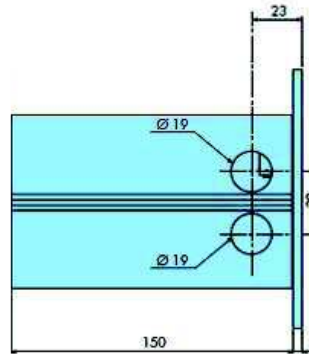

Mounting bracket length 250 mm.

AC 916.20.32

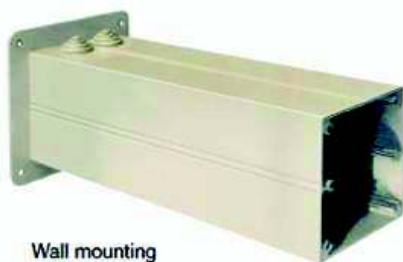

Wall mounting

To mount series M10200 - M10400 door holders in a surface position.
Box in aluminium with two plastic pass-cables (min 5mm - max 16mm)
Press tubes are optional
Length 250mm

